



# Southington Center

Southington, CT

A high-performing Walmart anchors Southington Center, a retail hub that features a fully signalized entrance on Queen Street (SR 10), a frequently travelled location at the region’s main retail corridor. The center’s multi-faceted tenant mix includes Sally Beauty, GameStop, Tap Out Fitness and Santander Bank. Additional tenant categories include wine & spirits, nails, lighting and casual dining.

Traffic Count - 16,900 per day

## Overview

**235 Queen St.  
Southington, CT 06489**

**For Lease**

**County:** Hartford

**Type:** Retail

**Total SF:** 155,842

## Retailers Include

- GameStop
- NAMCO
- Walmart

## Leasing Representative

**Melanie Medeiros**

📍 500 Franklin Village Drive, Ste 110  
Franklin, MA 02038

📞 508-365-3526

📠 508-541-0082

✉️ mmedeiros@cdrt.com

## Property Manager

**Joseph Mileto**

📍 44 S. Bayles Avenue, Ste 304 Port  
Washington, NY 11050

📞 516-944-4563

📠 347-398-2635

📠 516-767-6497

✉️ jmileto@cdrt.com

Demographics	3 Miles	5 Miles	10 Miles
Population	38,236	105,863	178,242
Households	15,968	44,044	73,511
Average HH Income (\$)	108,515	99,220	86,175

# Southington Center - Site Plan

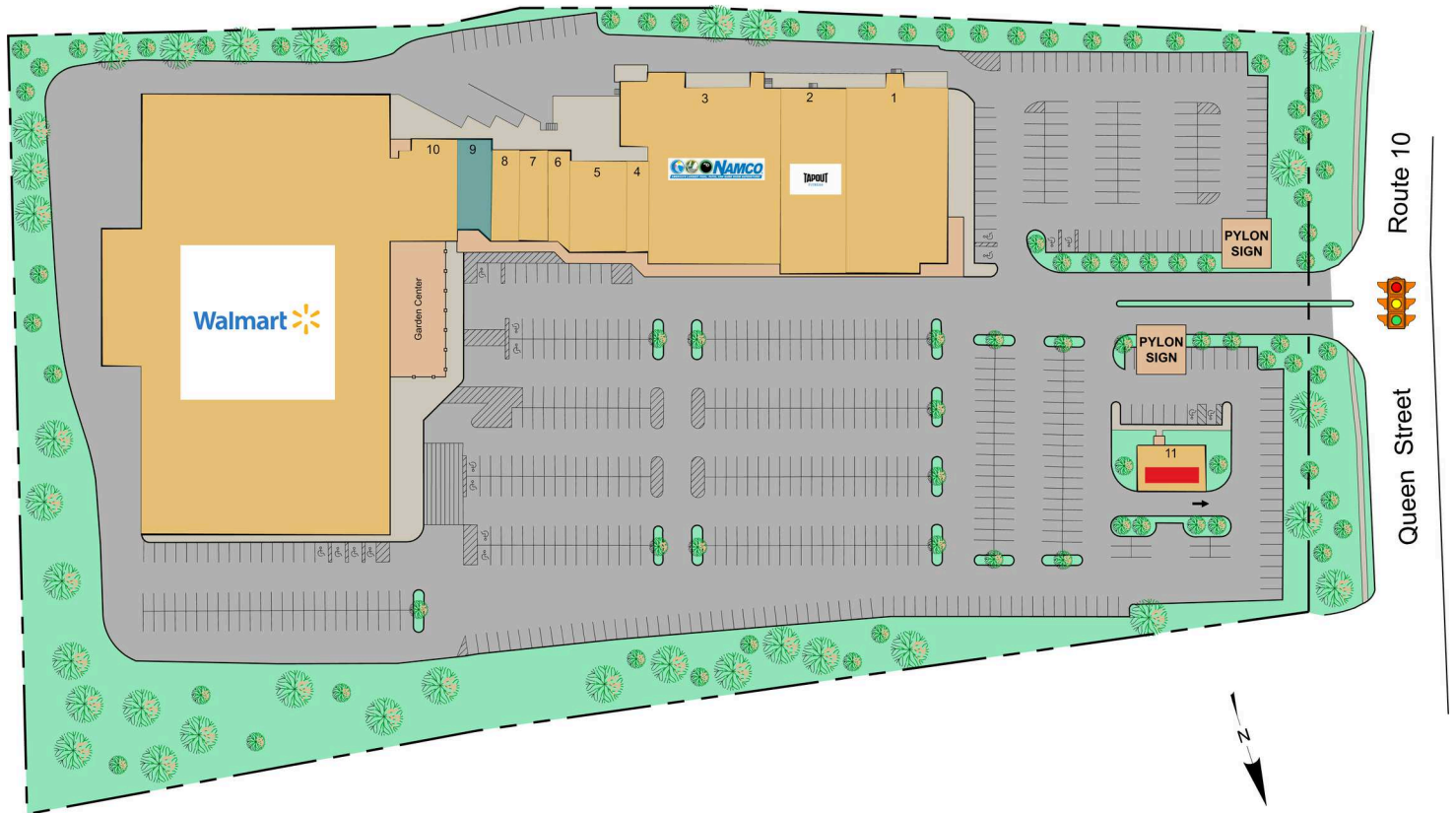

1	Southington Wine & Spirit	14,612 SF	7	GameStop	1,967 SF
2	Tapout Fitness	10,000 SF	8	Star Nails	2,000 SF
3	NAMCO	20,000 SF	9	Available	2,335 SF
4	Great Clips	1,134 SF	10	Walmart	95,482 SF
5	Noble Japanese Steakhouse	3,975 SF	11	Santander Bank	2,700 SF
6	Sally Beauty Supply	1,637 SF			



**Corporate Headquarters**  
 44 South Bayles Avenue  
 Port Washington, NY 11050  
 516.767.6492